

1A - Pipe details

name of pipe: _____
 pipe makers name: _____
 tuning: _____

2A

outer diameter of the tube: _____

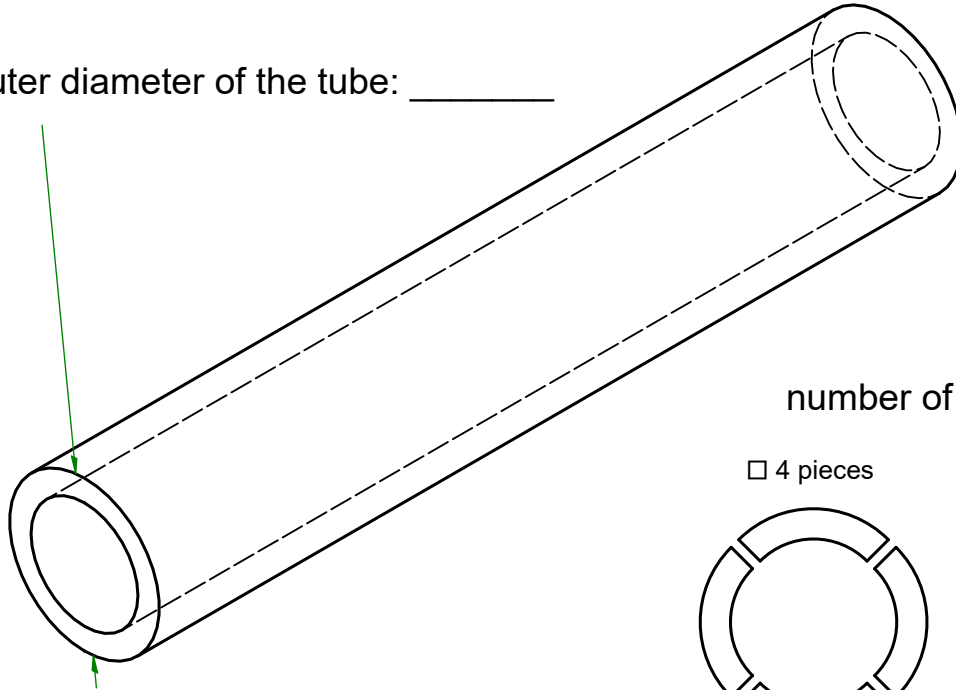

number of segments:

4 pieces

5 pieces

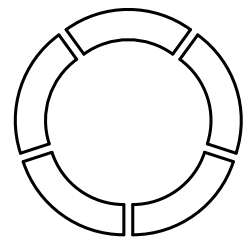
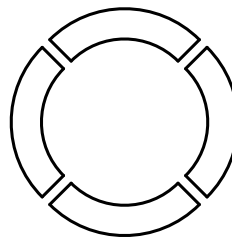

3A - length of cut: _____

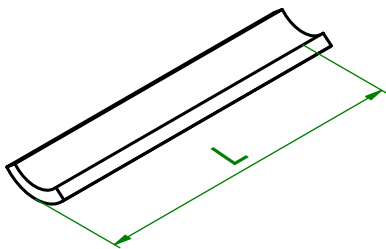

3B

inner diameter: _____

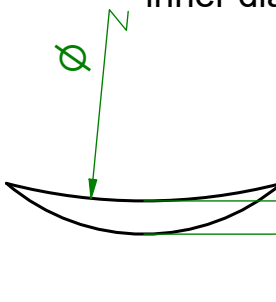

thickness minimum: _____

thickness maximum: _____

Datum/Date :	Bestell-Nr./Order No. :	Rohrholzbeamaßung Dudelsack <i>Pipe cane measurements</i>	
Kunde/Customer :			1
Kunden-Nr./Customer Code :	<small>Schutzvermerk nach DIN 34 beachten.</small> Reeds 'n Stuff	04-13100-FB1	A4
	<small>A_Defining_Tube_cane.ipt</small>		

4A - shaper form name / engraving: _____
 (max. 4 letters)

dimensions:

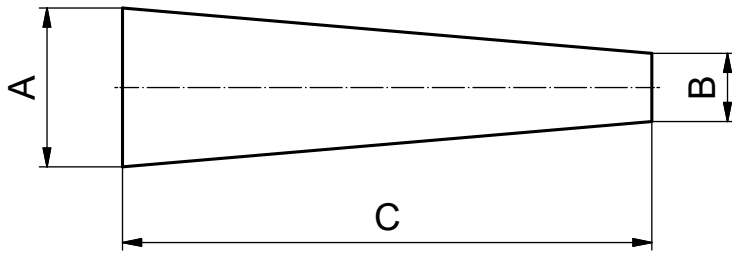

A = _____ *

B = _____

C = _____

For a curved shaper form, please include 5 examples of shaped cane.

4B - blade options:

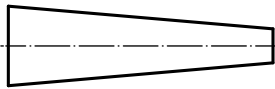

SB - single blade

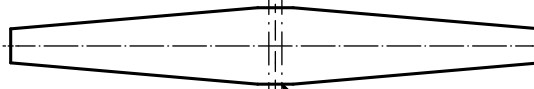

DB - double blade

please add 2 mm length for a better start of the blade (*)

4C - angle of the cutted side:



Standard

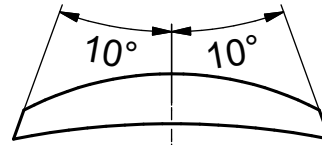

Slanted (10°)

5A - reed thickness after profiling:

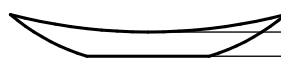
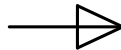

minimum: _____

maximum: _____

6A - profile:

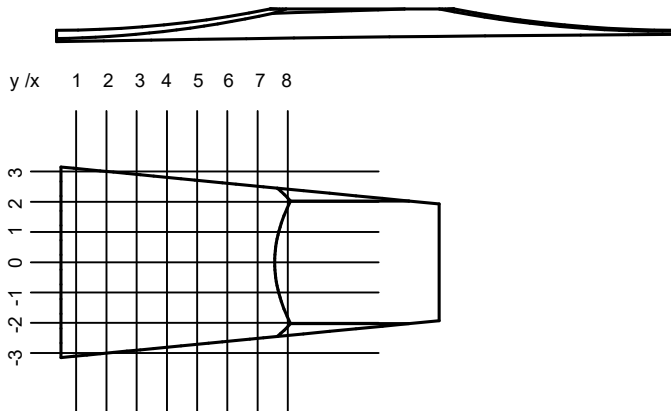

x / y	0	+/- 1	+/- 2	+/- 3
1				
2				
3				
4				
5				
6				
7				
8				

For the right profile please give us the measuring data for the heights like it's shown in the figure left or send a sample of your reed to us.

Datum/Date :	Bestell-Nr./Order No. :	Rohrholzbemaßung Dudelsack <i>Pipe cane measurements</i>	
Kunde/Customer :			2
Kunden-Nr./Customer Code :	<small>Schutzvermerk nach DIN 34 beachten.</small> Reeds 'n Stuff	04-13100-FB1	A4
	<small>C_Defining_Shape_Single.ipt</small>		